



The NEXT User Manual

Note: All pictures in this manual are for reference only, please refer to the actual product.

● Safety Warning and Precautions

Before using this device, please read this manual thoroughly and know the following precautions in order to optimize the use and lifespan of the device.

1. Operating Environment

Do not place the product in dusty and humid environments. This could cause an internal short circuit. Do not place the product near heating devices (such as electrical heater).

The operating temperature is 0-40°C or 32-104°F. The operating humidity is 10%-90%RH.

2. Safety for young children

The product and its accessories may contain small parts. Please keep these items out of the reach of young children because it can cause a choking hazard.

3. Power Supply

Please use the included, standard power adapter.

4. Keep Dry

The product is NOT waterproof or water resistant. Please keep it dry.

5. Maintenance

Please contact technical support for maintenance services. The U.S. Support Team can be reached at 864-643-5045, or chat or a support ticket can be submitted from our website www.getcleartouch.com

Do not insert any sharp or pointed object into the device.

Treat the device carefully to avoid rough impact with a surface that could cause permanent damage to the device.

● Statement

1. Intellectual property right statement: Patent Pending. The patents cover the hardware design and software of this product. Anyone who reproduces the product or the contents of this manual without prior written permission from Clear Touch shall be liable to legal prosecutions.

2. The description, illustrations, etc. in this document are subject to change per the latest product specification and performance.

3. The product images are for illustrative purposes only and may differ in appearance, color, size, etc. from the actual product.

4. Clear Touch reserves the rights to improve and change the appearance and design of the product without notice.

● Product Function

The list below provides an overview of the hardware, I/O, and functions on the device.

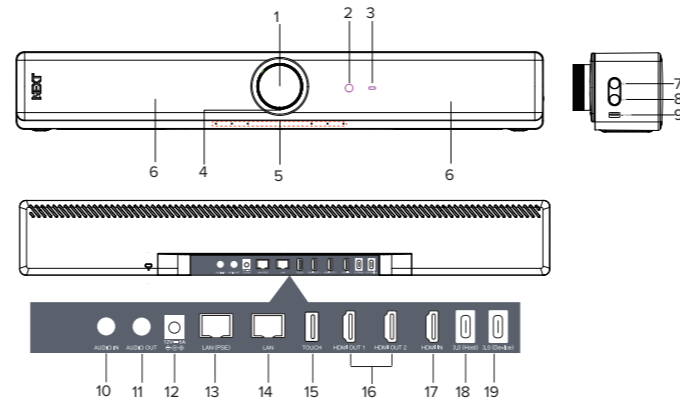

No.	Items	No.	Items
1	Camera: with twist on/off lens cover	10	AUDIO IN
2	Power LED: No light: power off White blinking: during boot-up White: power on Blue blinking: BT standby Red: microphone muted	11	AUDIO OUT
		12	12V=5A DC 2.0
3	Remote control receiver signal	13	LAN (PSE): Connected to Ethernet, Support for15W PSE
4	Camera LED: white on/off	14	LAN: Connected to Ethernet
5	Microphone	15	TOUCH: Support touch retransmission
6	Loudspeaker	16	HDMI OUT 1 & 2
7	⏻ Power button: Press and hold 3s to turn on/off device	17	HDMI IN
8	📶 Bluetooth button: Press to turn on BT; Press and hold for 9s to enter RC pairing mode	18	3.0 (Host):USB Type-C, video & audio transmit
9	3.0 (Host): USB Type-A, video & audio transmit	19	3.0 (Device): Support display input/video & audio transmit / touch / network (no charging provided)

● Mounting

- Placed directly on a flat surface.

- TV mount (V-Mount): Secure the bars to the VESA mounts of the IFP and attach the NEXT to the mount with hand-tightened screws. They can be put above the screen or below the screen.

For detailed instructions, refer to this guide: <http://tinyurl.com/NEXT-Mount>



- Clamp mount: Fix the NEXT onto the clamp mount using hand-tightened screws, then hang the clamp mount at the middle top position of the IFP. To further secure the Clamp, use the included zip-ties to mount the clamp to the VESA brackets or mount of the mobile stand. This mount can only be used to mount the NEXT to the top of the display.

1.

1. Open the wall mount bracket's fixed round tube outward and slowly place the machine on top of the bracket at an appropriate position.
2. Adjust the opening angle of the wall mount bracket's fixed round tube so that it fits tightly against the back of the machine, ensuring a stable and reliable installation.
3. It is necessary to pass two cable ties through the round holes on both sides of the wall mount bracket and thread them through the pillars or holes on the bracket. Slowly tighten the cable ties to prevent the machine from accidentally falling and causing harm. (Do not overtighten the cable ties to avoid tilting the machine. If the cable ties are still not long enough, you can connect the other two cable ties to make a longer one for use.)

2.

1. Use two 1/4" imperial screws to secure the bar and clamp mount through the holes in the bottom. Be careful to tighten the screws to avoid loosening and shaking.

3.

1. Place the NEXT on the wall bracket, align it with the two screw holes, and adjust the NEXT to the correct position.
2. Use two 1/4" screws to pass through the screw holes and tighten the machine onto the wall bracket.

4.

Finish installation

Safety warning: When using the Clamp mount, be sure to use nylon cable ties. Thread them through the safety holes of the clamp mount and tie them to the mounting hole of the bracket (or the VESA rivet of the IFP). This will keep the NEXT from falling off the top of the IFP.

Wall Mount: Please follow these steps for installation.

1.

1. Place the NEXT on the wall bracket, align it with the two screw holes, and adjust the NEXT to the correct position.
2. Use two 1/4" screws to pass through the screw holes and tighten the machine onto the wall bracket.

3.

1. Take out the wall bracket and place it evenly on the predetermined position on the wall. Use a black pen to mark the three drilling positions.
2. Use the corresponding drill bit to drill three round holes and insert three expansion plugs.
3. First, insert one self-tapping screw through the middle hole of the wall bracket and tighten it slightly. Then, insert the other self-tapping screws through the wall bracket and finally tighten all the self-tapping screws.

2.

If it looks level, admire your work and tell others what has been accomplished here!

4.



● **How to Connect**

1. NEXT & laptop

Plug and play, all-in-one device which provides excellent audio and video capabilities.

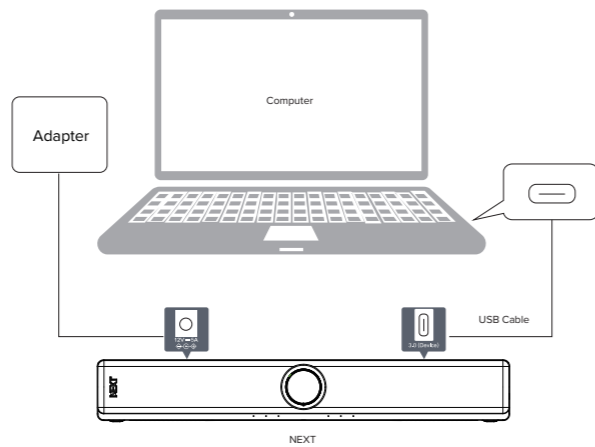

2. IFP & NEXT

Connect NEXT and IFP to provide the latest Android 13 system; simultaneously support dual-screen display and network transmission.

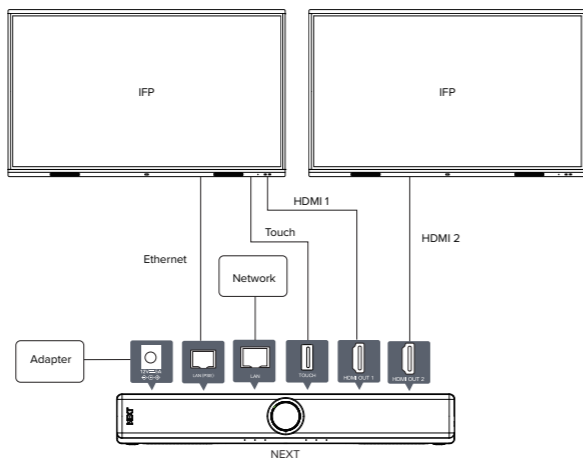

3. IFP, NEXT, and laptop (HDMI & USB)

Connect a computer with an HDMI cable and a USB A to C cable to transmit display, audio, and video to and IFP, and achieve multiple points of touch.

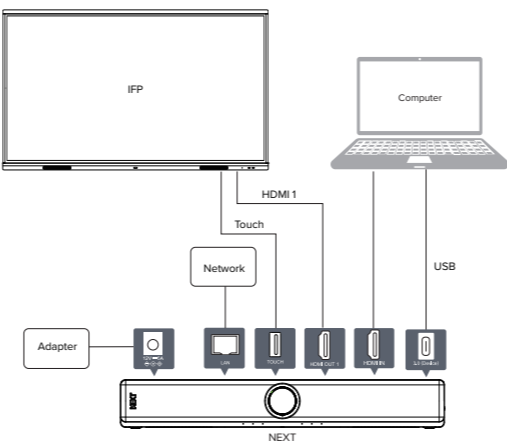

4. IFP, NEXT, and laptop (USB-C)

Connect a computer with a USB Type-C cable to transmit display, audio, and video to an IFP and achieve points of touch.

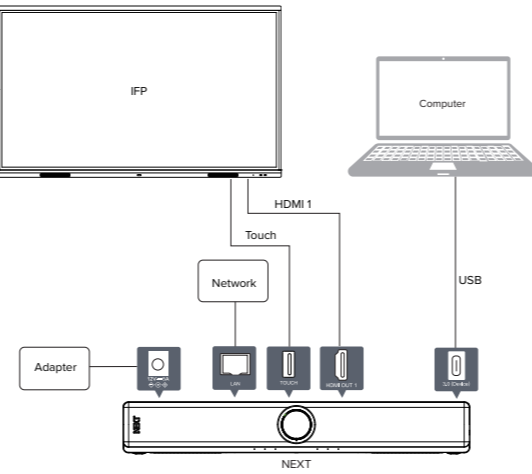

5. NEXT and Collar Mic

Pair with a collar microphone to achieve voice amplification

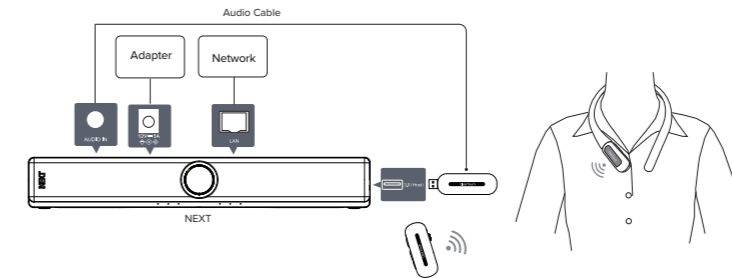

Notes:

- Please confirm that the pairing is completed.
- The supplied power adapter is suitable for use with 100-240V AC power only.
- Be conscious of the power load when you use extension cords or multiple outlet surge protectors.
- The illustration is for your reference only

● **Remote Control**

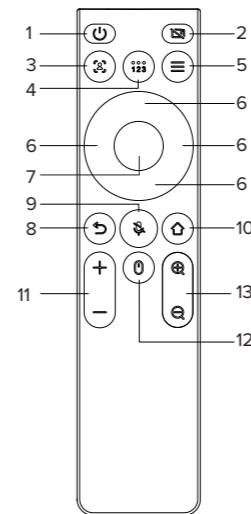

1. : Power Button
 - Short press: external display device will show 10s countdown shutdown, click OK to shut down, click cancel to cancel the current operation;
 - Press and hold for 3s to enter the shutdown state.
2. : Camera Switch, enable or disable the camera.

3. : Switch the camera mode. The default is panoramic mode. Press to switch to Auto-Framing, and press again to switch to speaker tracking.

4. : Presets

- Short press cycle to switch the preset function (mode 1, mode 2, mode 3). If Autoframing is on when pressed, Autoframing will be automatically cancelled in response to preset bit switching.
- Hold down to set the preset mode. Default: can be adjusted freely, but cannot be saved. To switch to any mode, hold down to save it in the corresponding mode.

5. : Menu Button, open the menu function. It contains application switch, recently used application, task clearing and other functions can be operated.

6. Direction Button

7. OK Button:

- Navigation keys;
- Control the top, bottom, left and right of the camera.

8. : Return Button

- Return to previous page;
- With the home button, long press 3s to achieve Bluetooth pairing function.

9. : Turn on/off the microphone

10. : Home Button

- Return to the home page;
- With the return button, long press 3s to achieve Bluetooth pairing.

11. : Volume Button

- Adjust system volume
- Hold down the OK button and then press volume "+" or volume "-" to adjust the wireless mouse sensitivity.

12. : Wireless mouse, turn on/off the wireless mouse

13. : Digital Zooming, digital camera focus, zoom in or zoom out the picture can use the direction button to move the picture perspective; Mutually exclusive with Autoframing.

● **Accessories Introduction**

Please check the following items in the product box.

HDMI Cable × 2	Audio Cable × 2	AC Cable × 2
USB (C-C)Cable × 1	Ethernet Cable × 1	Clamp Mount × 1
USB (A-C) Cable × 2	Cable Management × 4	TV Mount × 1
USB (A-B)Cable × 1	Remote Control × 1	Wall Mount × 1